

**German Shepherd Dog Club
Of
Southern Arizona, Inc.**

PROGRAM OF JUDGING

**March 23 and 24, 2019
Specialty Shows
&
4 to 6 Month Beginner Puppy Classes
&
All-Breed Obedience and Rally Trials**



Located At:

**ORA MAE HARN PARK
13250 N. Lon Adams Rd.
Marana, AZ 85653**

Show Secretary:

**Beverly Porter
12431 W Mile Wide Rd
Tucson, Arizona 8574
Bevp.showsec@outlook.com
(520) 334-7467**

LEGEND:
G - Grooming Area
F - Food Vendor Area
H - Hospitality

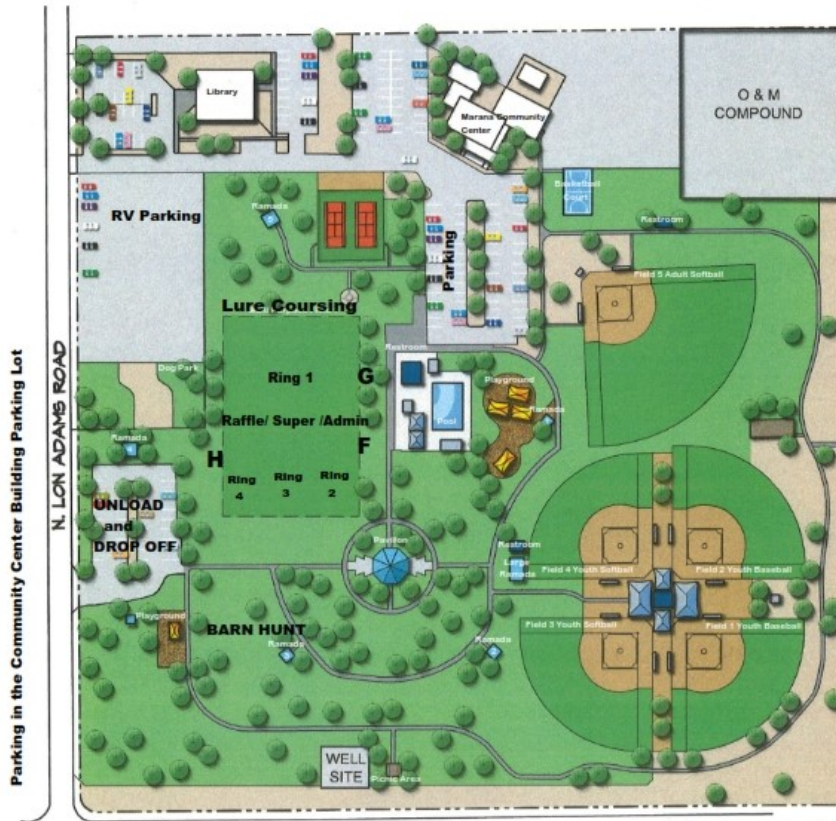

ORA MAE HARN DISTRICT PARK



Parking in the Community Center Building Parking Lot

N. LON ADAMS ROAD

CONFORMATION

JUDGING SCHEDULE

All judging will be held in Ring 1

March 23, 2019

Judge: Mrs. Karin E. Wagner

8:30 AM Event #2019080602 4 to 6 Month Beginner Puppy (1)

8:45 AM Event #2019080601 Dogs 7, Bitches 10, BOB (1,0)

There is a total of 17 dogs & 1 beginner puppy entered in the Saturday show.

March 24, 2019

Judge: Mrs. Frances J. Rood

8:30AM Event #2019080605 4 to 6 Month Beginner Puppy (1)

8:45 AM Event #2019080603 Dogs 7, Bitches 10, BOB (0,2), Veteran (1)

There is a total of 17 dogs and 1 beginner puppy entered in the Sunday show.

POINT SCHEDULE

(Effective May 16, 2018)

1pt: 2 Dogs, 2 Bitches

2pt: 4 Dogs, 5 Bitches

3pt: 7 Dogs, 8 Bitches

4pt: 8 Dogs, 9 Bitches

5pt: 11 Dogs, 14 Bitches



AKC CANINE GOOD CITIZEN TESTING (CGC) & COMMUNITY CANINE TESTING (CGCA) & AKC TRICK DOG TESTING (TKN)



SATURDAY, March 23, 2019

Testing starts after the last Rally class finishes.

- The fee for either test is \$15.00 per dog & is due at the time you take the test.
- If your dog already has it's CGC, that will count as 5 of the 10 required tricks for the Novice title.
- Entries can be made for either test at the Club booth/tent Friday evening March 22nd and through the day on Saturday, March 23rd.

For information about testing please contact:

Steve Watterson
email: stwaus@comcast.net

Find out about the Canine Good Citizen, Canine Community Program and AKC Trick Dog at www.AKC.org.

Please note that anyone doing Trick Dog testing is responsible for bringing their own trick props, ie., hoops, tunnels, etc.

DOGS LEFT IN PARKED CARS

All persons attending this show hereby waive any claim for damages against the GSDCSAZ, Inc. , the club members or agents in the event a vehicle must be entered into in order to rescue a dog from overheating or suffocation due to improper ventilation.

In the event it becomes necessary to rescue an animal from a parked car on the show grounds or in parking areas immediately surrounding the show grounds, the GSDCSAZ, Inc. will not be held liable for any damages incurred as a result of rescuing the animals.

Furthermore, if the rescue has to be performed by virtue of negligence, the owner, agent or any other person responsible for the rescued animal WILL be subjected to an Event Committee hearing as approved by the rules of the AKC.

SHOW GROUNDS AVAILABILITY

- RV parking will be available starting at 1 PM on Friday, March 22, 2019.
- Setups can begin on Friday, March 22nd at 4PM
- All setups must be removed by show closing on Sunday, March 24th.
- Setups can remain on the park grounds overnight during the show but the GSDCSAZ, Inc. is not responsible for any theft or property damage. The Marana Police Department is located behind the park on the North side and, there will be GSDCSAZ club members staying the night at the park.

PUBLICATION RIGHTS:

By entering this show, all owners, handlers, breeders and kennels agree that all rights to photograph, advertise, promote and publicize this show, or the persons or animals participating in it shall belong solely to GSDCSAZ, Inc.

- All trophies must be claimed the day of the show - None will be mailed.
- Entry Fee will not be refunded in the event that a dog is absent, disqualified, excused by Veterinarian or judge or barred from competition by action of the Show Committee.
- Exhibitors should follow their veterinarian's recommendation to assure their dogs are free of internal and external parasites, any communicable diseases and have appropriate vaccinations.
- No entry fees will be refunded if the Show cannot open or be completed by reason of riots, civil disturbances, fire, extreme and/or dangerous weather conditions, an Act of God, public emergency, act of a public enemy, strikes or any other cause beyond the control of the Club or the Superintendent.
- The show giving Club, the Show Superintendent, their agents, employees, etc., assume no responsibility for any loss, damage or injury sustained by exhibitors, handlers, or to any of their dogs or property and further assume no responsibility for injury to children.
- Exhibitors and handlers will be held responsible for clean conditions in and around their crates.

Saturday, March 23, 2109
Event #2019080601

OBEDIENCE

OBEDIENCE RING 4

JUDGE: *Mr. Alvin Eng*

START	CLASS	COUNT	ARM BAND #
08:30 AM	Open A	5	201, 202, 203, 204, 205
09:10 AM	Open B	5	111, 113, 112, 114, 115
09:50 AM	Utility A	2	501, 502
10:05 AM	Utility B	5	111, 601, 112, 602, 113
10:50 AM	Graduate Novice	2	1001, 1002
11:05 AM	Graduate Open	1	1201
11:15 AM	Preferred Open	3	1101, 1102, 1103
11:40 AM	Brace	1	3001

OBEDIENCE RING 2

JUDGE: *Mr. Carl P. Lentz*

START	CLASS	COUNT	ARM BAND #
08:30 AM	Novice A	2	12,13
08:50 AM	Novice B	7	101, 102, 104, 107, 108, 109, 110
09:50 AM	Beginner Novice A	3	701, 702, 703
10:10 AM	Beginner Novice B	7	801, 802, 804, 805, 806, 807,808
10:55 AM	Preferred Novice	1	901

There are **40 dogs** entered with a total of **43 entries** and **1 Brace** entry in Saturday's Obedience Trial

Armband numbers are ordered by jump height, short to tall

Sunday, March 24, 2109 OBEDIENCE

Event #2019080603

OBEDIENCE RING 4

JUDGE: *Mr. Carl P. Lentz*

START	CLASS	COUNT	ARM BAND #
08:30 AM	Utility B	5	111, 112, 602, 603, 113
09:10 AM	Utility A	2	501, 502
09:30 AM	Open B	4	111, 112, 115, 113
10:05 AM	Open A	5	201, 202, 203, 204, 205
10:45 AM	Graduate Novice	2	1002, 1001
11:05 AM	Preferred Open	3	1101, 1102, 1103

OBEDIENCE RING 2

JUDGE: *Mrs. Linda Scanlon*

START	CLASS	COUNT	ARM BAND #
08:30 AM	Novice B	8	101-104, 106, 108-110
09:35 AM	Novice A	3	11, 12, 13
10:00 AM	Preferred Novice	1	901
10:10 AM	Beginner Novice B	5	801, 803, 804, 806, 807
10:45 AM	Beginner Novice A	3	701, 702, 703

There are **38 dogs** entered in regular classes with a total of **41 entries** in Sunday's Obedience Trial

Armbands are ordered by Jump Height from short to tall

Saturday, March 23, 2109 RALLY

Event #2019080607

RALLY RING 2

JUDGE: *Mr. Carl P. Lentz*

START	CLASS	COUNT	ARM BAND #
11:30 AM	Walkthrough		
	Novice A	9	2201-2209
To Follow	Novice B	8	2301, 2303-2305, 2308-2311
	Walkthrough		
	Intermediate	6	3101, 3102, 3103, 3104, 3105, 3106, 3107

DIRECTIONS TO THE SHOW SITE

ORA MAE HARN PARK

13250 N LON ADAMS RD., MARANA, AZ 85653

From I-10 going East towards Tucson:

- Take **Exit 236** (Marana Rd.) and immediately get onto the **Frontage Rd.** traveling East (towards Tucson).
- Turn right onto **N. McDuff Road**
- Turn left onto **W. Grier Road**
- Turn right onto **N. Lon Adams Rd.** The park is about half a mile down the road.

From I-10 going West from Tucson:

- Take **Exit 240** (W. Tangerine Rd.) and immediately get onto the **Frontage Rd.** traveling West (towards Marana).
- Turn left onto **W. Barnett Rd.**
- Turn right onto **N. Lon Adams Rd.** You will see the park.

If you are coming in a large vehicle, we recommend using the Tangerine Road (Exit 240) from I-10 (either North or South bound). There is some construction in the area and using Tangerine Road will be easier for maneuvering your large vehicle or RV.

ABOUT THIS PARK

This is a pretty park away from the hustle and bustle, located in a small country town. The ring area is a nice, flat, grassy field with plenty of room. There are plenty of locations for pop up tents not too far from the rings.

Parks and Rec is not allowing exhibitors to stake their setups at the show site. If you are bringing a pop-up, please plan on using weights rather than stakes.

A grooming area for bathing and drying will be available.

RAFFLE ~ RAFFLE ~ RAFFLE

Raffle items are located under our tents (between the conformation and rally rings).

Our 50/50 Raffle is another way to win some cash! We split the pot half and half with the winner.

Winners will be announced on Saturday afternoon.

HOTEL INFORMATION

Below is a list of local pet friendly hotels.

Each of these hotels are easily accessed from Interstate 10 and are close to the park and amenities.

The Days Inn

8370 N Cracker Barrel Rd, Tucson, AZ 85743

(520) 744-6677

Rates from \$64.00 11.8 miles from show site (15 minutes)

La Quinta Inn & Suites

6020 W Hospitality Rd, Tucson, AZ 85743

(520) 572-4235

Rates from \$119 11.9 miles from show site (16 minutes)

The Red Roof Inn

4940 W Ina Rd, Tucson, AZ 85743

(520) 744-8199

Rates from \$99.00 12.5 miles from show site (20 minutes)

Motel 6 Tucson North

4630 W Ina Rd, Tucson, AZ 85741

(520) 744-9300

Rates from \$52 13.1 miles from show site (20 minutes)

Please note that the INA ROAD exit from I-10 may be CLOSED due to construction. You may need to allow for extra driving time.

RV PARKING

***There is a one-time \$25 charge for overnight RV parking .
RVs must be self-contained.***

RVs will be able to park at the show but cannot remain overnight. Overnight parking for RVs is in the North Parking Lot adjacent to the park.

Reservation Required. First Come, First Serve. If you do not make a reservation, we cannot guarantee that space will be available for you.

If you are coming in an RV:

please contact the show chairman, **Theresa Tuttle** at sundancerlabs@aol.com for instructions and to reserve a parking spot.

Saturday, March 23, 2109

RALLY

Event #2019080607

RALLY RING 3

JUDGE: Mrs. Linda Scanlon

START	CLASS	COUNT	ARM BAND #
08:30 AM	Walkthrough		
08:40 AM	Advanced A	2	2402, 2403
	Advanced B	12	2502, 2503, 3201, 2703, 3202, 2708, 3204, 2510, 2707, 2711, 2513, 2514
09:25 AM	Walkthrough		
09:35 AM	Excellent A	2	2601, 2602
	Excellent B	9	2703, 3201, 2704, 3202, 2706, 2707, 2708, 2711, 3204
10:10 AM	Walkthrough		
10:20 AM	Master	8	3201, 3202, 3203, 3204, 3205, 3206, 3208, 3209
11:10 AM	Walkthrough		
11:20 AM	Pairs Novice	4	5001, 5002, 5003, 5004
To Follow	Walkthrough		
	Pairs Intermediate	1	6001
	Walkthrough		
	Teams Novice	2	7001, 7002
	Walkthrough		
	Teams Advanced	1	8101

There are **44 dogs** entered with a total of **56 entries** for regular classes in Saturday's Rally Trial

There are **5 Pairs** and **3 Teams**

Armbands are ordered by Jump Height from short to tall

Sunday, March 23, 2109 RALLY

Event #2019080608

RALLY RING 2 JUDGE: Mrs. Linda Scanlon

START	CLASS	COUNT	ARM BAND #
11:20 AM	Walkthrough		
	Intermediate	3	3102, 3105, 3107
To Follow	Walkthrough		
	Novice B	10	2301-2308, 2310, 2311
	Novice A	8	2201, 2203-2209

RALLY RING 3 JUDGE: Mr. Alvin Eng

START	CLASS	COUNT	ARM BAND #
08:30 AM	Walkthrough		
08:40 AM	Master	6	3201-3203, 3205, 3206, 3208
09:20 AM	Walkthrough		
09:30 AM	Excellent B	8	3201, 2704, 3202, 2706, 2707, 2708, 2709, 2711
	Excellent A	2	2601, 2602
10:05 AM	Walkthrough		
10:15 AM	Advanced B	9	2502, 2503, 3201, 3202, 2709, 2514, 2707, 2708, 2711
	Advanced A	2	2401, 2402
11:00 AM	Walkthrough		
11:10 AM	Pairs Intermediate	1	6001
11:20 AM	Walkthrough		
11:30 AM	Pairs Novice	1	5004

There are **40 dogs** entered with a total of **48 entries** in Sunday's Rally Trial

There are **2 Pairs**

Armbands are ordered by Jump Height from short to tall

HOSPITALITY NOTES

Coffee, Water and Sodas will be located in the hospitality area during the show and is available to anyone participating in the show.

Friday evening ... Everyone is invited to stop by for a slice of Pizza!

Breakfast pastries and fruit will be served on Saturday and Sunday morning.

Saturday evening Dinner is catered and is available for \$12 per person.



This year's theme is

HAWAIIAN

Please join us by wearing your favorite Hawaiian clothes



FRIDAY NIGHT

Sniff & Go!!!

Want to give Scent Work a try?

Novice- Containers & Exteriors \$5 per Element

Check in is at 5:30pm and Start time is 6:00pm on the show site at the park. Pre-register at www.gsdc saz.org

Obedience and Rally rings will be set up for practice

Pizza and water available

We do not charge for this activity, however, all donations are gladly accepted and go to the **Southwest German Shepherd Rescue**.

Saturday Night Dinner Buffet

You still have time to join us for a Hawaiian BBQ dinner on **Saturday evening!** **RSVP REQUIRED By 5pm on March 15th**

Saturday evening after the shows and trials is a great time to enjoy good food and visit with friends and other exhibitors.

See the attached flyer...only \$12 Per Person